

REV	DATE	DESCRIPTION	ECO	SIGN
1	11/21/96	RELEASE FOR QUOTING PURPOSES	437	RAB
		RELEASE TO PILOT		

WIRE COLOR CODE:

+ EXCITATION           YELLOW  
- EXCITATION           BLACK  
+ SIGNAL                WHITE  
- SIGNAL                RED  
SHIELD           1 OHM TO ELEMENT\*

\*(DYNAMIC LOAD CELL USED WITH T.T.I. PRODUCTION / LOAD MONITOR.)

INSTALLATION TORQUE SHOULD NOT EXCEED 525 IN-LB ON THIS END OF LOAD CELL

5 FEET STAINLESS STEEL METAL FLEX. HOSE  
6 FEET OF SENSOR CABLE.

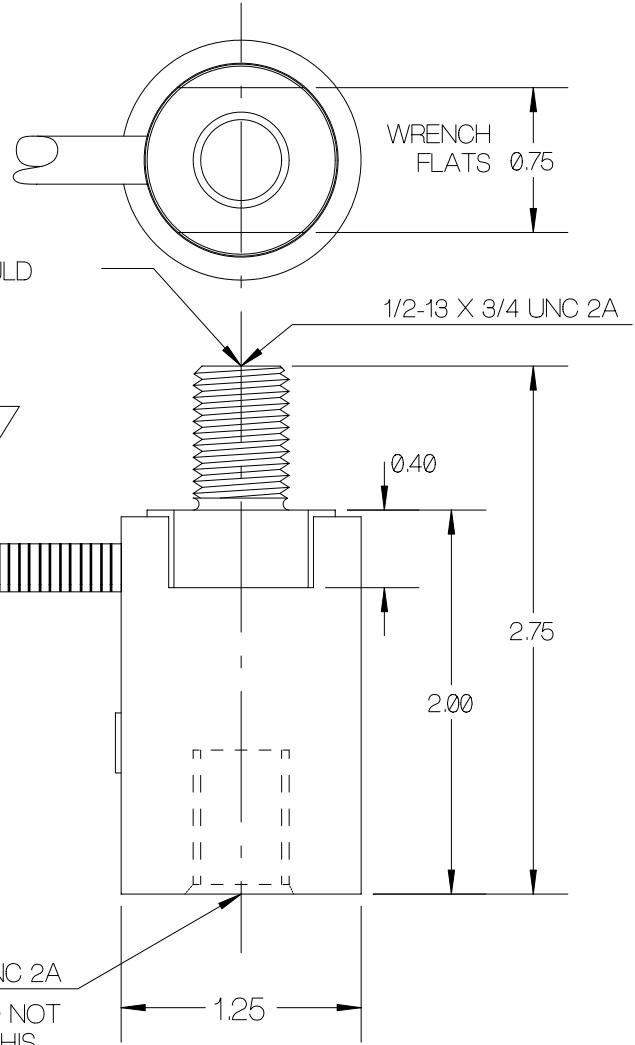

1/2-13 X 3/4 UNC 2A  
TOOL TORQUE SHOULD NOT EXCEED 250 IN-LB ON THIS END OF LOAD CELL

SPECIFICATIONS:

RATED CAPACITY	2,000 POUNDS
RATED OUTPUT	2 mV/V typical
COMBINED ERROR	0.25 %
NON-REPEATABILITY	0.05 %
ZERO BALANCE	± 1 %
TEMPERATURE RANGE, COMPENSATED	+14 TO 104° F
TEMPERATURE EFFECT, OUTPUT	0.014 % / ° F
TEMPERATURE EFFECT, ZERO BALANCE	0.05 % / ° F
INPUT IMPEDANCE	350 OHMS, typical
EXCITATION VOLTAGE (typical)	10 VDC or VAC rms
EXCITATION VOLTAGE, MAXIMUM	15 VDC or VAC rms
INSULATION RESISTANCE	5,000 MEG OHMS @ 50 VDC
MAXIMUM LOAD, SAFE	150 % F.S.
MAXIMUM LOAD, ULTIMATE	300 % F.S.

TOLERANCES UNLESS OTHERWISE SPECIFIED:	
.XXX = ± 0.005	SCALE: FULL
.XX = ± 0.015	
.X = ± 0.025	
FINISH: FINE BRUSHED FINISH, O.D. NO MARKS	
MAT'L: ALLOY STEEL / STAINLESS STEEL	



Designed By: **Mettert**  
Date: **11/15/96**  
Drawn By:  
Date:  
Approved By:  
Date:

Title / Description:  
**2KLb INSERTION LOAD CELL SPECIFICATIONS**  
Dwg. Size: **A**    Dwg. Type: **SPEC**  
Page 1 of 1

Part No. **SS1122-2K**  
File Name **10157SP.FCD**  
Doc. No. **10157**